

GALEO With remote electronics



Commercial



Industrial



Public
Buildings



Multi-tenant
occupancy



Residential

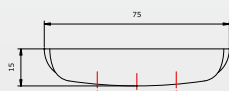
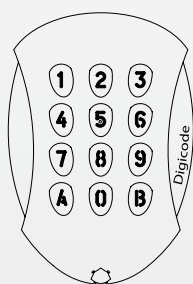
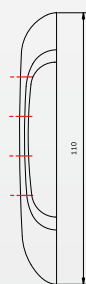
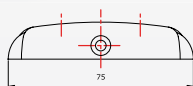

- **Cast aluminium.**
- **Backlit.**
- **Compact.**
- **1 to 3 relays.**
- **Surface mount.**
- **Free voltage.**
- **Mounting with Torx® screws**
- **Completely sealed with epoxy.**
- **PCB of remote electronics protected with a varnish coating.**
- **100 user codes.**
- **Available in Wiegand version (GALEOW).**
- Audible and visual feedback.
- Dimensions (L x W x D): 110 x 75 x 15mm.
- Power supplies:
 - 12 V to 24V ac,
 - 12 V to 48V dc.
- Consumptions: 30 to 100mA.



Recommended power supplies



ARD12



BS60



WEEE & RoHS



Environmental test:
Salt spray



IP64



CE certification



-25°C to +70°C



Remote
control included

| CODE | REFERENCE | DESCRIPTION |
|-------------|-----------|---|
| F0201000047 | GALEO | CAST-ALUMINIUM DIGICODE® KEYPAD - 1 RELAYS |
| F0201000048 | GALEO 2R | CAST-ALUMINIUM DIGICODE® KEYPAD - 2 RELAYS |
| F0201000049 | GALEO 3R | CAST-ALUMINIUM DIGICODE® KEYPAD - 3 RELAYS |
| F0702000089 | TM/GALEO | GALEO KEY MODULE (GALEO KEYPAD WITHOUT HOUSING) |